





How to Set Up CDU eduroam on your iPhone or iPad

How to Set Up CDU eduroam on an iPhone/iPad

This process is for Charles Darwin University staff or students and will assist you in setting up your iPhone to connect to the CDU Eduroam Wi-Fi service.

Steps for connecting to Eduroam:

	iPhone	iPad
<p>1.</p> <p>On your iPhone, locate the Settings icon and tap it.</p>		
<p>2.</p> <p>In Settings, locate WI-FI and tap it.</p>		

3.

Make sure WI-FI is turned on by tapping the **ON/OFF** button so **ON** is showing. The WI-FI screen should show the available CDU WI-FI services. Tap the **eduroam** option (do not tap it on the blue right pointing arrow).



4.

Enter your **eduroam** username and password.
For staff, your username is in the format `username@cdu.edu.au`. This means you would put your normal CDU username before the `@cdu.edu.au`. Your password is the normal password you use to log into your PC each day.
For students, your username is in the format `studentnumber@students.cdu.edu.au` e.g, `s123456@students.cdu.edu.au`. Use your normal password.
Tap **Join** when done.

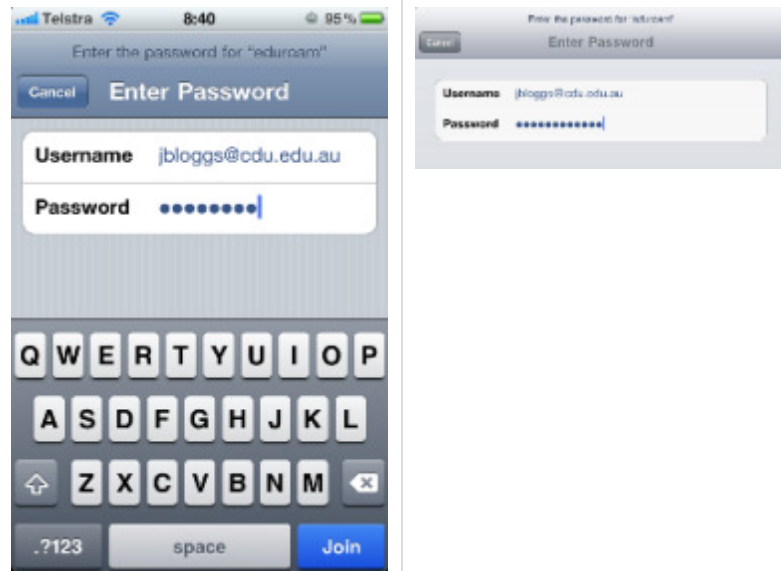

5.

Tap on **Accept** when the **Certificate** screen appears.

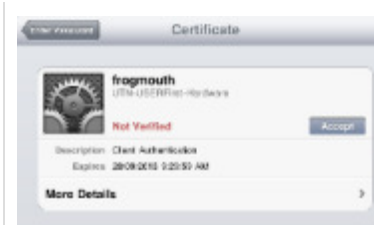
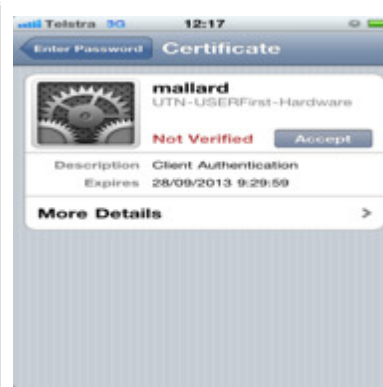

6.

Sometimes it may take your device a couple of attempts before it will join the network. Tap **Dismiss** and then tap **Join** again until it connects.

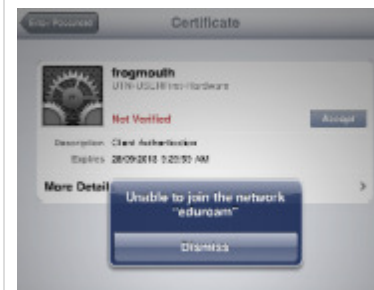
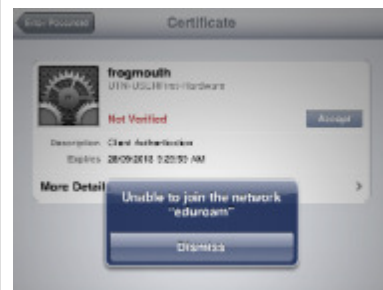

7.

The WI-FI Networks screen will appear and there will be a blue tick against the **eduroam** option if the connection was successful. Navigate out of the **Settings** menu and back to the **Home** screen.



8.

You should now see the WI-FI symbol appear next to **Telstra** replacing the **3G** symbol. It may take a few seconds before the phone switches between 3G and WI-FI.

When you leave the campus, your phone will switch back to 3G.

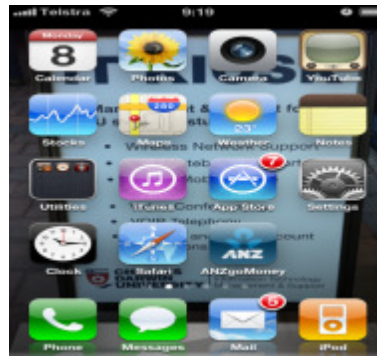

[Add Comment](#)